

Construction width 1100 mm

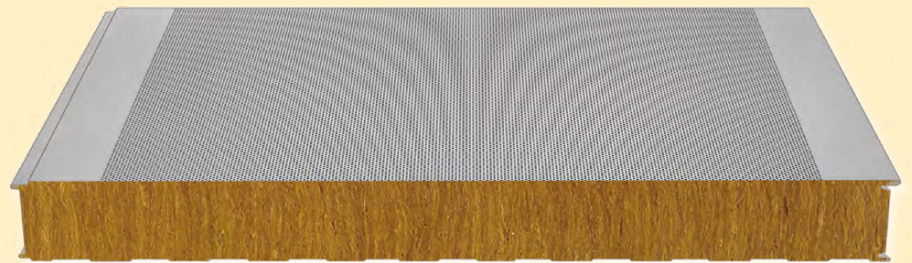

Symbolic picture

## BRUCHAPanel® Acoustic panel – WP-A

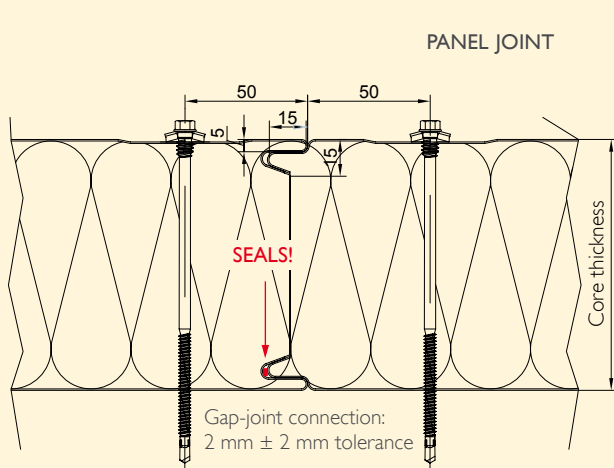

Gap-joint connection:  
2 mm ± 2 mm tolerance

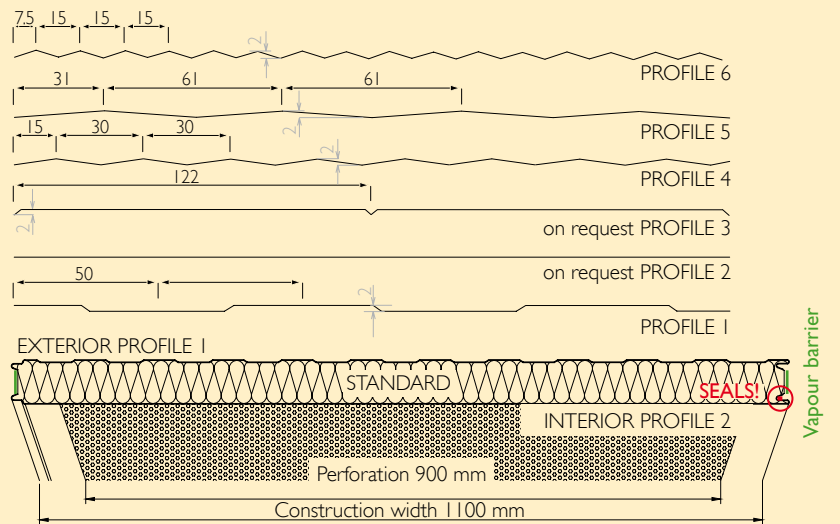

The **BRUCHAPanel Acoustic panel – WP-A** with perforated interior sheet and the economic construction width of 1100 mm allows a practice orientated and clean solution for acoustic absorption and airborne sound insulation for inside walls and suspended ceilings, as well as an optimal amelioration of the room acoustics.

The **BRUCHAPanel Acoustic panel – WP-A** enables an extremely fast and simple installation.

The joint design with the tongue and groove system enables the

panels to be mounted perfectly and results in a homogeneous surface. Between the inside sheet and the mineral wool core a fleece is used as a drip protection.

The acoustic panel can be used for wall cladding in non heated buildings following a necessary consultation to discuss the technical and structural details.

As the inner sheets of the panels are permeable for vapour diffusion its use as an exterior wall of a wet room in a heated building is restricted and not recommended prior to consultation.

### Technical data:

max. manufactured lengths: 15.0 m, metal gauge: 0.6 mm

Panel Type	Core Thickness mm	U-value W/m <sup>2</sup> K*	Weight /m <sup>2</sup> kg	Thermal resistance m <sup>2</sup> K/W	Sound Insulation R <sub>w</sub> dB	Degree of sound absorption α <sub>w</sub>	Fire Rating**
WP-A 60	60	0.67	15.7	1.35	~32	0.85	EI 30
WP-A 80	80	0.52	18.1	1.80	~32	0.85	EI 60
WP-A 100	100	0.42	20.5	2.30	~32	0.85	EI 90
WP-A 120	120	0.35	22.9	2.75	~32	0.85	EI 120
WP-A 150	150	0.31	26.5	3.45	~32	0.85	EI 120
WP-A 200	200	0.21	32.5	4.60	~32	0.85	EI 120

Degree of sound absorption α<sub>w</sub>/0,85  
Sound absorption level: B  
regarding test report MA39-VFA 2008-0448.01

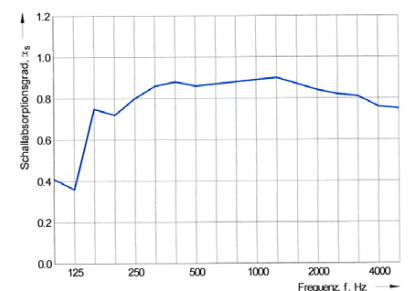

Minimum purchase of 300 sqm

Manufacturing tolerance according to EN 14509

Fire behaviour: Non combustible insulation core; without fire classification

Approval: on the basis of the general technical approval Z-10.49-610

Structural design: span tables will be issued on request

### Surface design:

**fleece:** glass fibre fleece SM60/10 as non drip protection

**hole ratio:** 32.5 %

**hole diameter:** 3 mm offset located

**perforation:** DIN RV 3-5(R3T5) (730-000)